

M12 L-coding (Power DC)

M12 L-coding Straight Connector, Panel, Solder & Crimp, Front fastened

Male

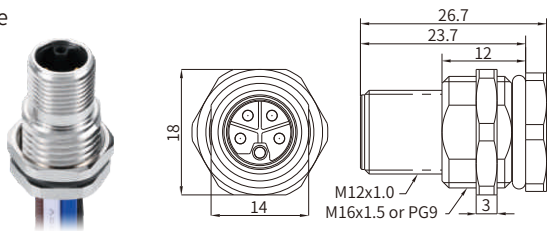

CE RoHS

Female

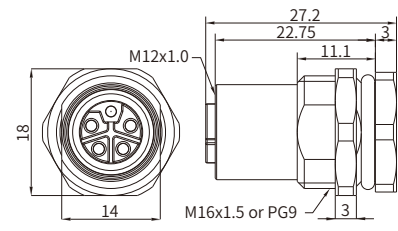

CE RoHS

Specifications

Contacts	5(4+PE)
Certification	US PVVA(PVVA7).E496340
Pin layout(Male)	
Pin layout(Female)	
Standard	IEC 61076-2-111
Ambient temperature	-15°C~+85°C (flexible installation), -30°C~+85°C (fixed installation)
Customized temperature	-25°C ~ +85°C (flexible installation), -40°C ~ +85°C (fixed installation)
Connector insert	PA
Connector contacts	Brass with gold plated
Coupling nut/screw	Brass with nickel plated
Seal/O-ring	FKM
Insulation resistance	≥100MΩ
Contact resistance	≤5mΩ
Earth tag/pin	Unavailable
IP rating	IP67, IP68 in locked condition
Mating endurance	>500 cycles
Rated current	16 A
Rated voltage	63V
Wire gauge	2.0mm ² (AWG14)
Panel cut-out	Refer to page 384

Part Number

Pins	Terminal Type	Cable length	Male		Female	
			M16x1.5	PG9	M16x1.5	PG9
5	Solder	0.1m	MB12MSLFF05ST-220001	MB12MSLFF05ST-320001	MB12FSLFF05ST-220001	MB12FSLFF05ST-320001
		0.3m	MB12MSLFF05ST-220003	MB12MSLFF05ST-320003	MB12FSLFF05ST-220003	MB12FSLFF05ST-320003
	Crimp	0.1m	MB12MCLFF05ST-220001	MB12MCLFF05ST-320001	MB12FCLFF05ST-220001	MB12FCLFF05ST-320001
		0.3m	MB12MCLFF05ST-220003	MB12MCLFF05ST-320003	MB12FCLFF05ST-220003	MB12FCLFF05ST-320003

Default wire colors

Pin No.	
Pin 1	BN
Pin 2	WH
Pin 3	BU
Pin 4	BK
Pin 5	YU/GN